

The Capable County

Name: _____

A. True or False? Circle true (T) or false (F) for each statement. If the statement is false, cross out the part that is wrong and correct it on the line below.

- Counties in the United States come from an ancient American Indian tradition. T or F
- Rules for counties and local governments are spelled out in the U.S. Constitution. T or F
- Counties have adapted to meet the needs of the communities they serve. T or F
- Counties all across the United States are managed the same way. T or F
- Most of counties' money comes from the federal government. T or F
- The first counties were units of government created as "districts." T or F
- The main in-county source of income for most counties is the sales tax. T or F
- A county executive can be fired by the county commission. T or F
- Unfunded mandates are services the federal government demands and pays for. T or F
- A county commission can act as both a legislative and executive branch. T or F

B. County Power. Label and define Home Rule and Dillon's Rule.

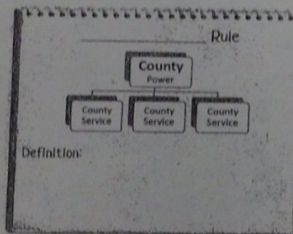
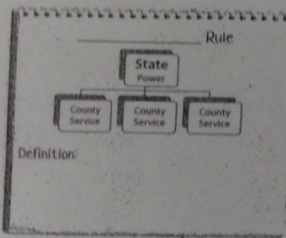

iCivics

Review Worksheet p.1

The Capable County

Name: _____

C. County to the Rescue! Help each person below find the county service they need.

- | | | |
|---|--|---------------------------|
| <input type="checkbox"/> I broke my arm, and I need to go to the emergency room. | <input type="checkbox"/> Sniffi I need a copy of my grandma's death certificate. | A. Hospital Services |
| <input type="checkbox"/> It's that time of year again—I need to get a flu shot. Ouch! | <input type="checkbox"/> I need counseling, but I can't afford it. | B. Property Records |
| <input type="checkbox"/> Help! Someone is trying to break into my apartment! | <input type="checkbox"/> Can they really build a gas station next to my house? | C. Mental Health Services |
| <input type="checkbox"/> I cleaned out my shed and loaded my truck full of trash. | <input type="checkbox"/> I just turned 18 and I can't wait to vote! | D. Waste Management |
| <input type="checkbox"/> I need a copy of the deed to my house. | <input type="checkbox"/> The road by my house has a big pothole. | E. Disease prevention |
| | | F. Road maintenance |
| | | G. Elections |
| | | H. Land Use Planning |
| | | I. Vital Records |

D. County Crossword. Use the clues and the reading to complete the crossword puzzle.

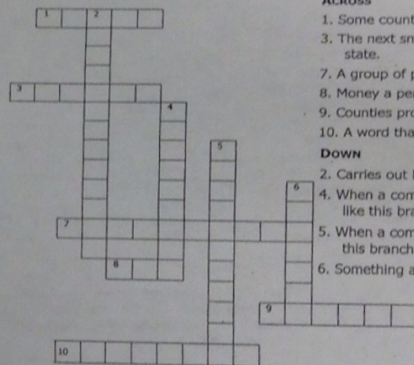

Across

- Some counties get their power from this.
- The next smallest unit of government below a state.
- A group of people in charge of a county
- Money a person pays for a county service
- Counties provide services directly to _____.
- A word that means "not paid for."

Down

- Carries out board decisions in some counties.
- When a commission decides the county's policies, it is like this branch of government.
- When a commission passes county laws, it is partly like this branch of government.
- Something a county has been ordered to do.

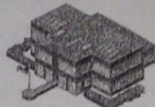

Review Worksheet p.2

iCivics